



24" X 24" SEWAGE BASIN PACKAGES



pentair.com/myers

PENTAIR® MYERS® 24" X 24" SEWAGE BASIN PACKAGES

The 24" x 24" Sewage Basin is designed to be installed in a basement floor to collect sewage or effluent water from toilet, washer, dishwasher or a sink so that it can be pumped away with a sewage or grinder pump.

- ◆ Pre-assembled from factory to help make installation quicker and easier than non-pre-assembled product.
- ◆ Cast iron sewage and grinder pump construction help to prolong pump life.
- ◆ Thicker* structure for enhanced durability.
- ◆ Specially designed bottom grooves for easier leveling in rough soil.
- ◆ Molded torque stops help keep pump in place.

SB24VRS10 shown with tethered float switch and optional SA-1 alarm

- ◆ 38.5 Gallon capacity for longer pump cycles prolonging the pump life.
- ◆ Pre-installed schedule 80 PVC pipe.
- ◆ Robust polyethylene structure that is thicker than previous models for superior durability.
- ◆ 5 Additional flats for adding or changing inlet pipe location.



SA-1

*Compared to previous models.

Optional Alarm Level for Improved Peace of Mind

- ◆ Quick connect terminal block
- ◆ Corrosion resistant construction
- ◆ Indoor, NEMA 1 enclosure
- ◆ Audible and visual alarm

FEATURES FOR ENHANCED PROTECTION



5 Corrosion resistant stainless steel bolts for a tighter connection.

6 Easy access holes for quicker inspection.

7 Molded torque stops help maintain pump placement for reduced maintenance.

8 Specially designed pads and grooves on the bottom for easier leveling in rough soil.

9 True round inlet with no pattern shift or parting line down the center to help prevent leaks.

PENTAIR® MYERS® 24" X 24" SEWAGE BASIN PACKAGES



ORDERING INFORMATION

SERIES	SB24SRM-01		SB24MW50-01		SB24VRS10	
HP	4/10		1/2		1	
Maximum Pump Capacity	115 GPM	435 LPM	135 GPM	511 LPM	49 GPM	185 LPM
Maximum Shut-off Head	18'	5.4 m	27'	8.2 m	61'	18.6 m
Discharge	2"	50.8 mm	2"	50.8 mm	2"	50.8 mm
Solids Handling	2"	50.8 mm	2"	50.8 mm	-	-
Volts	115		115		115	
Full Load Amps	13.0		9.0		13.0	
Phase	Single		Single		Single	
Cord Length	20'	6.1 m	20'	6.1 m	20'	6.1 m
Switch	Tethered		Tethered		Tethered	
Pump Impeller Material	Recessed Thermoplastic		Thermoplastic		Thermoplastic	
Pump Housing Material	Cast Iron		Cast Iron		Cast Iron	
Pump Volute Material	Cast Iron		Cast Iron		Cast Iron	
Basin Material	Polyethylene		Polyethylene		Polyethylene	
Basin Dimensions (W x H)	24" x 24"	609 mm x 609 mm	24" x 24"	609 mm x 609 mm	24" x 24"	609 mm x 609 mm
Basin Capacity	38.5 Gallons	145.7 Liters	38.5 Gallons	145.7 Liters	38.5 Gallons	145.7 Liters
Lid Material	Polyethylene		Polyethylene		Polyethylene	
Warranty Years	3		3		3 - with start-up report	

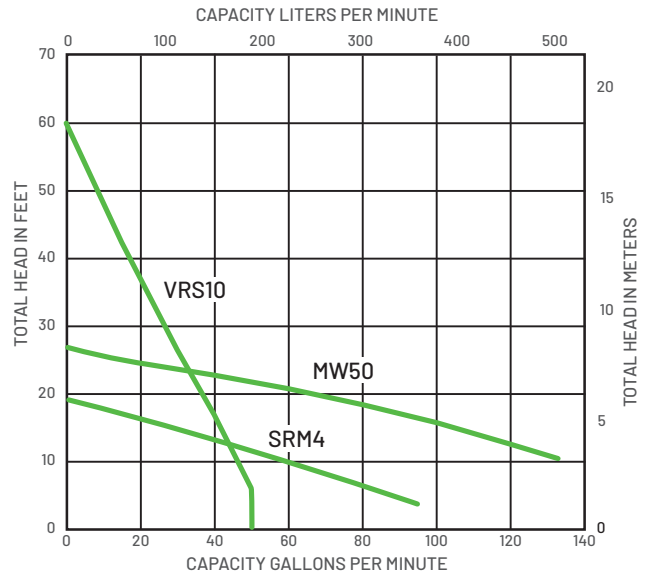
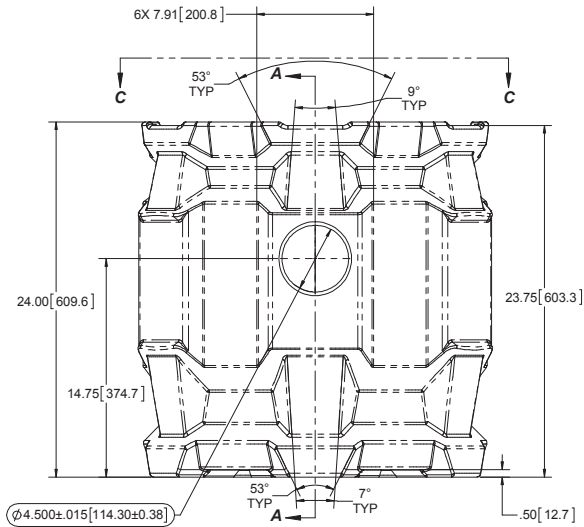

293 Wright Street
Delavan, WI 53115 USA
Ph: 888.987.8677
Orders Fax: 800.426.944

490 Pinebush Road
Unit 4, Cambridge,
Ontario N1t 0A5, Canada
Ph: 800.363.7867
Orders Fax: 888.606.5484

pentair.com

All indicated Pentair trademarks and logos are property of Pentair. Third party registered and unregistered trademarks and logos are the property of their respective owners.

©2024 Pentair. All Rights Reserved.

M12023SSE (07-15-24)