

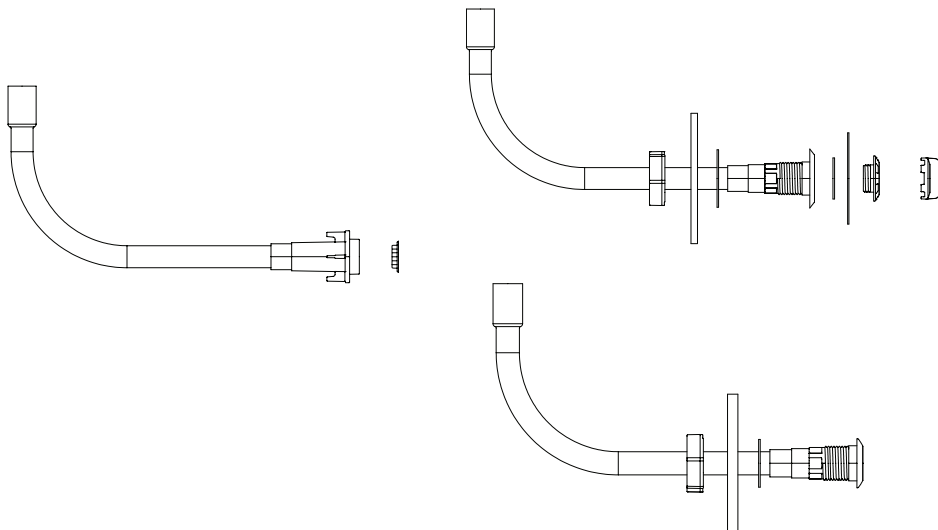

# INTELLIVIBE® NANO NICHE KITS

## INSTALLATION INSTRUCTIONS



IMPORTANT SAFETY INSTRUCTIONS  
READ AND FOLLOW ALL INSTRUCTIONS  
SAVE THESE INSTRUCTIONS

### CUSTOMER SERVICE / TECHNICAL SUPPORT

---

**Hours:** 9:00AM to 7:00PM EST (6:00AM - 4:00PM PST)

**Call:** (800) 831-7133

**Visit:** [www.pentair.com](http://www.pentair.com)

**Fax:** (800) 284-4151

## IMPORTANT WARNING AND SAFETY INSTRUCTIONS



**SERIOUS BODILY INJURY OR DEATH CAN RESULT IF THIS LIGHT IS NOT INSTALLED AND USED CORRECTLY.**



**INSTALLERS, POOL OPERATORS AND POOL OWNERS MUST READ THESE WARNINGS AND ALL INSTRUCTIONS BEFORE USING THE POOL AND/OR SPA LIGHT.**



Most states and local codes regulate the construction, installation, and operation of public pools and spas, and the construction of residential pools and spas. It is important to comply with these codes, many of which directly regulate the installation and use of this product. Consult your local building and health codes for more information.



**IMPORTANT NOTICE - Attention Installer:** This Installation and User's Guide ("Guide") contains important information about the installation, operation and safe use of this underwater pool and spa light. This Guide should be given to the owner and/or operator of this equipment.



Before installing this product, read and follow all warning notices and instructions in this Guide. Failure to follow warnings and instructions can result in severe injury, death, or property damage.

Call (800) 831-7133 for additional free copies of these instructions. Please refer to [www.pentair.com](http://www.pentair.com) for more information related to this products.



**RISK OF ELECTRICAL SHOCK OR ELECTROCUTION: UNDERWATER POOL LIGHTS REQUIRE HIGH VOLTAGE WHICH CAN SHOCK, BURN, OR CAUSE DEATH.**

**Before working or servicing pool lights, always disconnect power to the pool and/or spa lights at the source circuit breaker. Failure to do so could result in death or serious injury to service person, pool users or others due to electric shock. When installing and using this electrical equipment, basic safety precautions should always be followed.**

This product must be installed by a licensed or certified electrician or a qualified pool professional in accordance with the current National Electrical Code (NEC), NFPA 70 or the Canadian Electrical Code (CEC), CSA C22.1. All applicable local installation codes and ordinances must also be adhered to. Improper installation will create an electrical hazard which could result in death or serious injury to pool users, installers or others due to electrical shock, and may also cause damage to power source. Always disconnect the power to the pool light at the circuit breaker before installing or removing the light. Failure to do so could result in death or serious injury to service person, pool users or others due to electrical shock.

## IMPORTANT WARNING AND SAFETY INSTRUCTIONS

**⚠ WARNING** For countries in compliance with International Electrotechnical Commission (IEC) regulatory standards: The light fixture must be installed by a licensed or certified electrician or a qualified pool service person, in accordance with current IEC 364-7-702 and all applicable local codes and ordinance. Improper installation will create an electrical hazard, which could result in death or serious injury to pool user, installer or other due to electrical shock and may also cause damage to the property.

### INSTALLERS AND INSPECTORS

**THE LIGHT AND WALL FITTING FORM A COMPLETE NON-METALLIC LOW VOLTAGE LIGHTING SYSTEM. THIS CONFIGURATION DOES NOT REQUIRE BONDING OR GROUNDING WHEN POWERED BY A POOL RATED 300 WATT ISOLATION TRANSFORMER AND INSTALLED IN COMPLIANCE WITH THE CURRENT NATIONAL ELECTRIC CODE (NEC).**

**NOTICE:** The light power cord has three conductors. The black and white conductors are for power. The green conductor is a communication wire and is not intended for grounding. All three conductors must be connected to the IntelliVibe controller directly or via a junction box.

**UNBONDED LIGHTING NEC PROVISIONS:** When the non-metallic low voltage lights are used, the current NEC provides an exception to luminaire bonding and grounding in Article 680.6 and 680.23.

**POOL WATER BONDING NEC PROVISIONS:** For Pool Water Bonding required by NEC Article 680.26C, concrete pools are considered conductive (refer to 680.26 (b)(1) due to the porosity of concrete and the bonding of rebar. No additional bonding is required.

**POOL AND SPA FIXED LUMINAIRES:** Follow these guidelines when installing or replacing Pentair fixed luminaires:

**FOR LIGHT OPERATION, ONLY USE A SAFETY ISOLATION TRANSFORMER.**

**FIXED POOL AND SPA CONTROLLER SPECIFICATION: 14 VAC 50/60 Hz.**

IntelliVibe Nano Lights are approved to be installed in a vertical position (facing up).

Vertical light installations are recommended only in non-occupant areas of the pool (e.g. up-lighting a vanishing edge overspill).

# INSTALLATION

This document provides installation instructions for IntelliVibe Nano Niche Kits. To properly dry conduit install an IntelliVibe Nano light, one of the following kits is required.

For light installation instructions, refer to the *IntelliVibe Nano Installation and User's Guide (P/N 619143)*.



Scan the QR code to access all IntelliVibe manuals.

## Gunite Kit (P/N 602271)

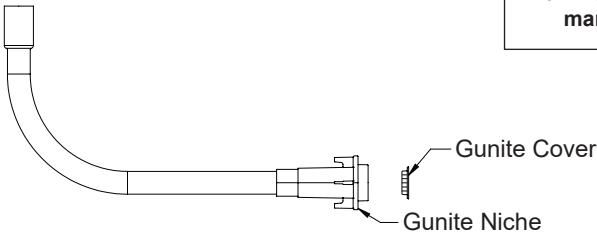

## Vinyl Kit (P/N 602272)

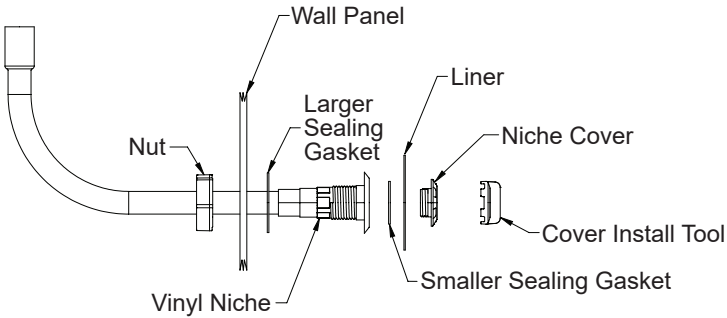

## Fiberglass Kit (P/N 602273)

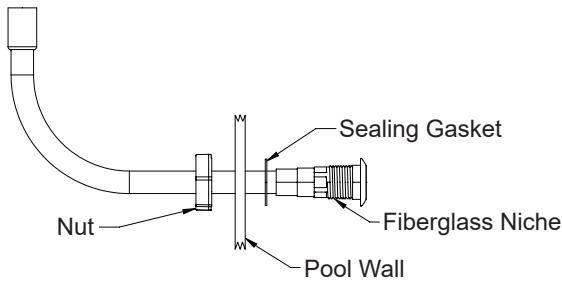

## INSTALLING A GUNITE NICHE (P/N 602271)

1. Install niche onto 1/2-inch trade size schedule 40 PVC conduit with Transition Cement rated for connection of PVC to ABS.
2. Before applying gunite, install the gunite cover in niche. The cover prevents gunite from entering the niche and conduit.
3. Complete gunite and surface finishing.
4. Remove and discard the gunite cover.

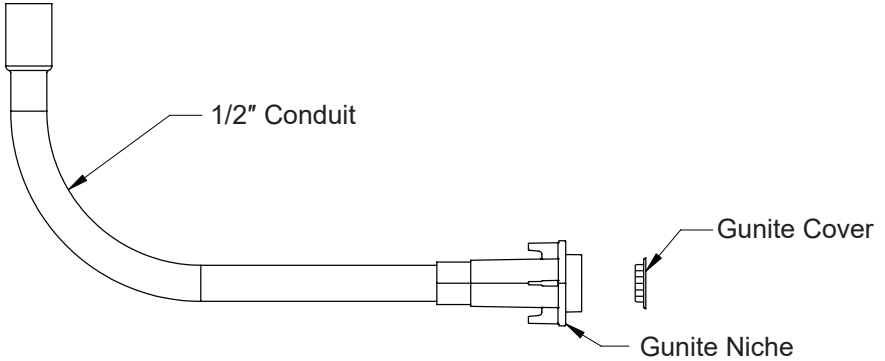

**INSTALLING A VINYL NICHE (P/N 602272)**

- 1. Drill a 1-5/16 inch hole in the pool wall panel.
- 2. Install the larger sealing gasket onto the vinyl niche.
- 3. From the inside of the pool, insert the vinyl niche through the 1-5/16 inch hole.
- 4. Install the plastic nut onto the back of the niche. Hand tighten the nut to secure the niche in place.
- 5. Place the smaller sealing gasket onto the front of the niche as shown below.
- 6. Install the vinyl liner.
- 7. Install niche onto 1/2-inch trade size schedule 40 PVC conduit with Transition Cement rated for connection of PVC to ABS.
- 8. Using the cover install tool, secure the niche cover and create a seal to the vinyl liner.

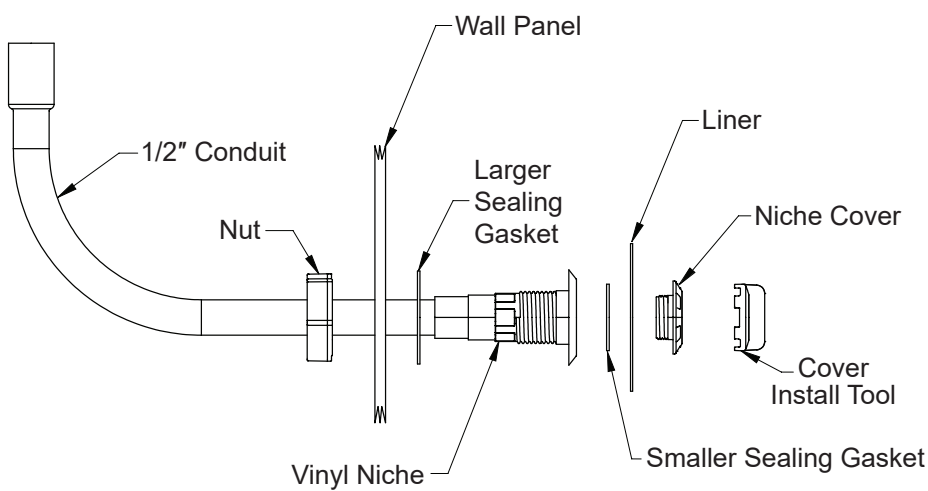

**VINYL NICHE COVER OPTIONS**

PART NUMBER	DESCRIPTION
619114	Niche Cover, Gray (Qty. 5)
619120	Niche Cover, White (Qty. 5)
619126	Niche Cover, Tan (Qty. 5)
619132	Niche Cover, Black (Qty. 5)
619138	Niche Cover, Blue (Qty. 5)

## INSTALLING A FIBERGLASS NICHE (P/N 602273)

1. Drill or punch a 1-5/16 inch hole in the pool wall panel.
2. Place the sealing gasket on the niche.
3. Insert the niche through the 1-5/16 inch hole in the pool wall.
4. Install the plastic nut onto the back of the niche. Hand tighten the nut to secure the niche in place.
5. Install niche onto 1/2-inch trade size schedule 40 PVC conduit with Transition Cement rated for connection of PVC to ABS.

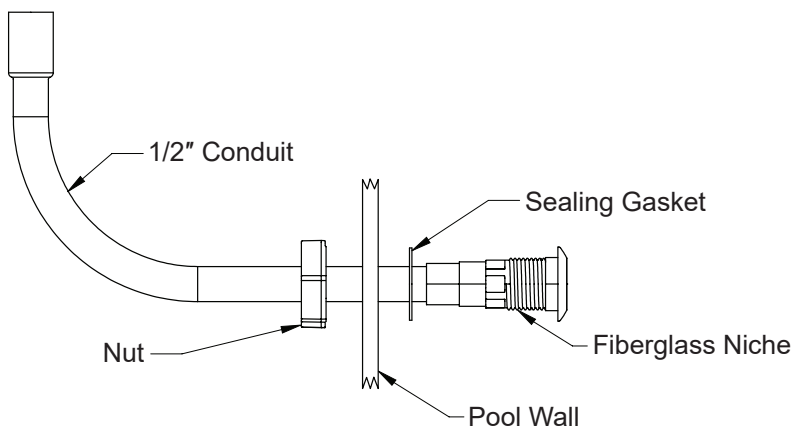



1620 HAWKINS AVE., SANFORD, NC 27330 • (919) 566-8000  
10951 WEST LOS ANGELES AVE., MOORPARK, CA 93021 • (805) 553-5000

All indicated Pentair trademarks and logos are property of Pentair. Third party registered and unregistered trademarks and logos are the property of their respective owners.

© 2025 Pentair. All rights reserved. [WWW.PENTAIR.COM](http://WWW.PENTAIR.COM)



P/N 619148 REV. A 3/25/25